

**Notes**  
 Copyright and not to be reproduced without the consent of Holmes Miller. Holmes Miller does not accept liability for accuracy or veracity of survey information provided by others and horizontal dimensions and levels provided by Holmes Miller and based on survey information provided by others must be verified on site. DO NOT SCALE: Use figured dimensions only.

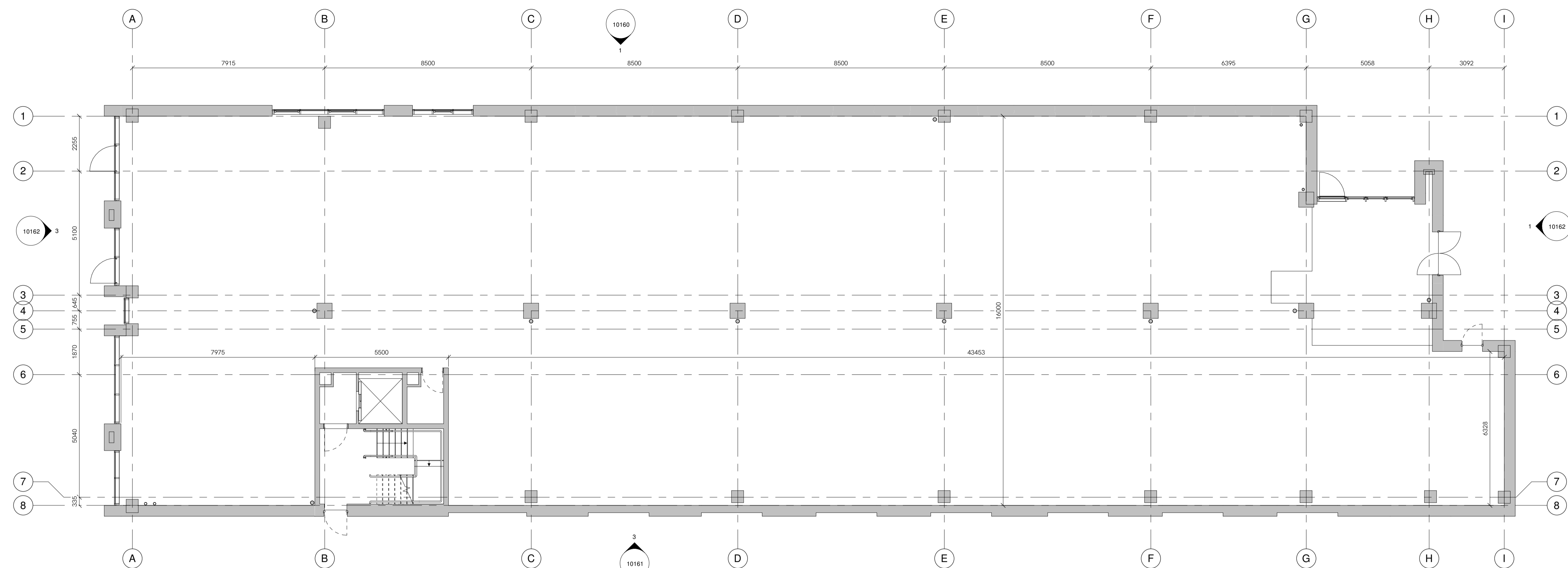

LEVEL 00 EXISTING  
 1:100

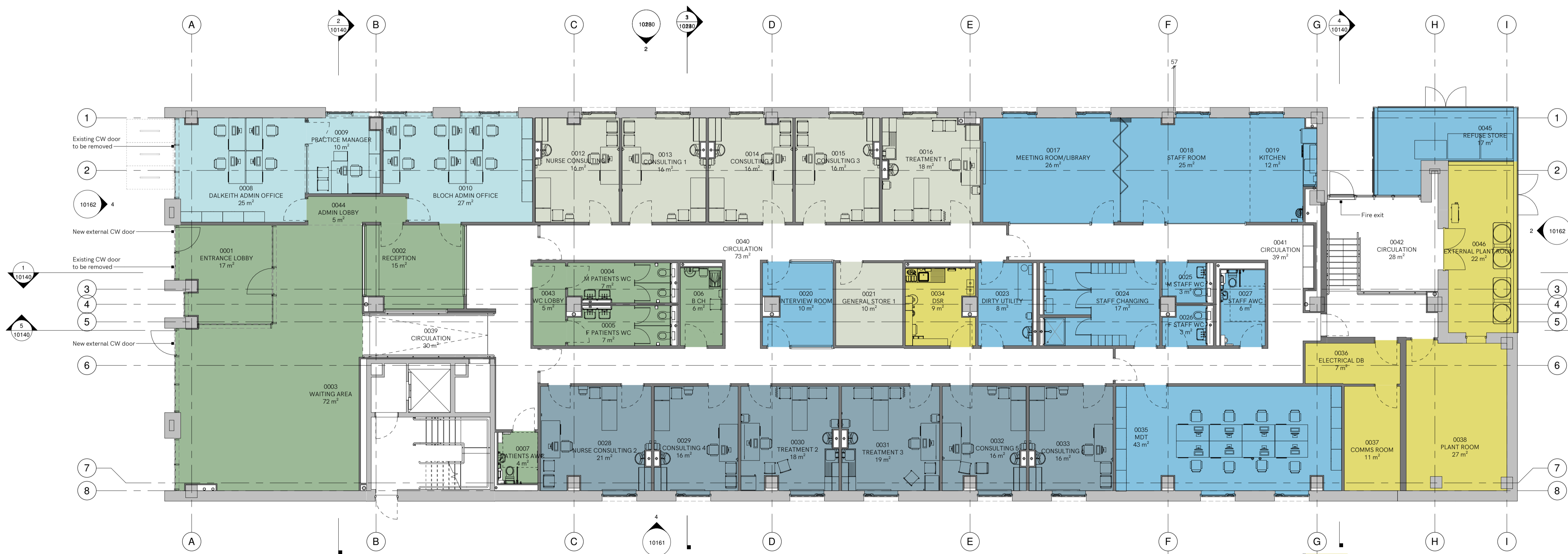

LEVEL 00 PROPOSED  
 1:100

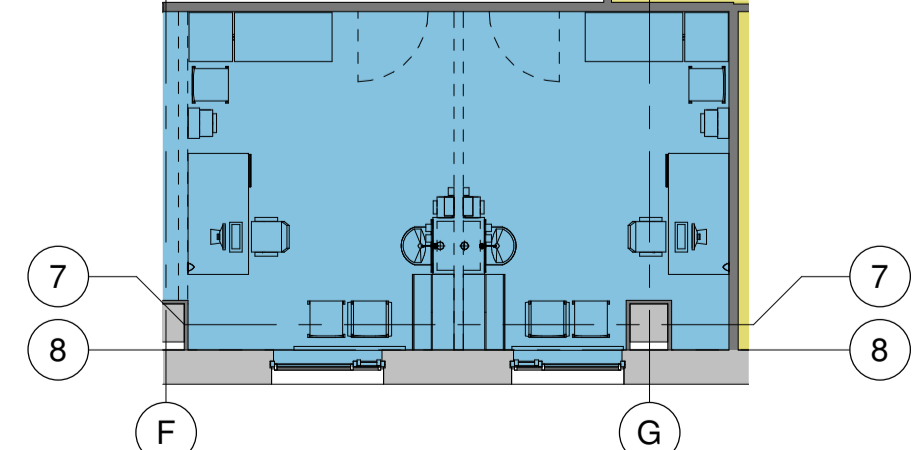

PROPOSED MDT FUTURE CHANGE  
 1:100

Rev	Notes	GA	DG	Drawn	Appr	Date
P08	M&E information added for external plant area	GA	DG			19.10.20
P07	Amended internal layout	GA	ADM			24.09.20
P06	External plant room and refuse store. Amended fire exit.	GA	DG			07.08.20
P05	Amended layout to incorporate new floor level and external windows location. Ramp added.	GA	DG			29.07.20
P04	Revised reception desk, lobby to patients toilets, babychange layout and corridor doors as per client latest request.	GA	DG			19.05.20
P03	MDT room layout and future consulting room arrangement added.	GA	DG			15.05.20
P02	Floor plan amendments. BCh Room added and redistribution of central amenities.	GA	DG			07.05.20
P01	First issue	GA	DG			28.04.20

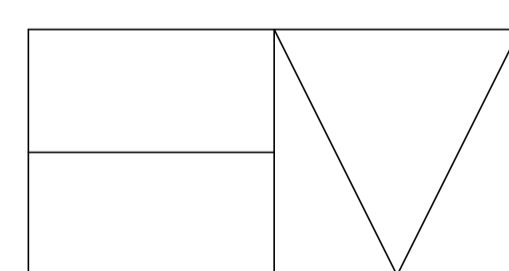

**Holmes Miller**  
 89 Minerva Street  
 Glasgow  
 G3 8LE  
 0141 204 2080  
 www.holmesmiller.com

**Project** 4632  
**St Leonards Medical Centre, Edinburgh**

**Drawing Name**  
**Floor Plan - Level 00 Existing & Proposed**

Scale @ A1	Checked	Revision
1 : 100	DG	P08

**Drawing Number**  
 4632-HML-ZZ-00-DR-A-10100